

Project: \_\_\_\_\_

Fixture Type: \_\_\_\_\_ Quantity: \_\_\_\_\_

Customer: \_\_\_\_\_

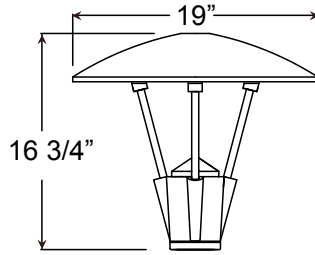

**Specifications**

**Material:**  
All parts are durable 356 cast aluminum and high strength aluminum spinnings. All hardware provided shall be stainless steel or zinc plated steel.

**Fixture Mounting:**  
Post Mount: Post Cap with set screws. Fits 3" and 4" poles.

**Drivers:**  
Universal voltage 120-277 is standard. 0-10V, TRIAC and ELV dimming to 1% protocols are standard for LED modules.

See page 2 table for LED module and driver specs, voltage and dimming protocols.

**Electrical:**  
Approximately 12" of pull wire extends from luminaire. Additional pull wire provided for post mount arms and wall mounts.



**Finish:**  
A polyester powder coat high quality finish is electro-statically applied and baked at 430° for exceptional durability and color retention. Products undergo an intensive five-step cleansing and pretreatment process for maximum paint adhesion.

Marine grade finish provides superior salt, humidity and UV protection. This coating withstands up to 3000 hours of continuous salt spray, comes with a 5-year warranty and is available in either a textured or gloss surface.

**Modifications:**  
Consult factory for custom or modified designs.

**LA210  
LED**

**Weight:** 15.0 lbs  
**EPA:** 0.5

Catalog Logic

LA210 1 M024LD D W 40K - PC - PA5651 - 72

Luminaire Series    Pendant or Post Mount    Light Source & Wattage    Dimming    Optics    CCT    Accessories    Mounting Source    Finish

Catalog Number

|       |   |   |   |   |   |   |   |
|-------|---|---|---|---|---|---|---|
| 1     | 2 | 3 | 4 | 5 | 6 | 7 | 8 |
| LA210 | 1 | D |   |   |   |   |   |

**1** **FIXTURE ORIENTATION**

|        |
|--------|
| 1 Post |
|--------|

**2** **LIGHT SOURCE & WATTAGES**

|        |                                |
|--------|--------------------------------|
| M016LD | (16w, 2000 lumen, Cree module) |
| M024LD | (24w, 3000 lumen, Cree module) |

**3** **DIMMING**

|  |
|--|
| D (Dimming)  |
| See page 2 table for LED engine and driver specs, voltage and dimming protocols. |

**4** **OPTICS**

|   |  |
|---|--|
| W | (T5 Wide Distributon with Dome LED Lens)   |
| N | (T5 Narrow Distributon with Flat LED Lens) |

**5** **COLOR TEMPERATURE (CCT)**

|     |         |
|-----|---------|
| 27K | (2700K) |
| 30K | (3000K) |
| 35K | (3500K) |
| 40K | (4000K) |

**6** **ACCESSORIES**

|            |  |
|------------|--|
| HSS90      | (90° House Side Shield, polished)                                    |
| HSS120     | (120° House Side Shield, polished)                                   |
| *EMG-LED5  | (5w, LED Emergency Driver, remote placement, Cree module only)       |
| *EMG-LED7  | (7w, LED Emergency Driver, remote placement, Cree module only)       |
| *EMG-LED10 | (10w, LED Emergency Driver, remote placement, Cree module only)      |
| HLMSPC-06  | (High-Low Motion Sensor/Photocell; 15' - 30' Sensor Mounting Height) |
| HLMSPC-10  | (High-Low Motion Sensor/Photocell; 8' - 15' Sensor Mounting Height)  |
| PC         | (Button Photo Cell)  |
| SP         | (Surge Protector, 10kA & 10kV)                                       |
| TLPC       | (Twist Lock photo cell & receptacle)                                 |
| TL         | (Twist Lock receptacle only)   |
| TL5        | (5-pin Twist Lock receptacle only)                                   |
| TL7        | (7-pin Twist Lock receptacle only)                                   |

\*For Emergency lumen output data, see Resources section at [www.ANPlighting.com](http://www.ANPlighting.com).

**7** **MOUNTING SOURCE**

| Post Mount Arms<br>*See Page 3 for Style/Size |              | Wall Mount Arms<br>*See Page 3 for Style/Size |        |
|---|--------------|---|--------|
| PA3321  | PA8521       | WM2141  | WM7421 |
| PA5151  | PA8571       | WM2211  | WM8021 |
| PA5411  |              | WM3001  |        |
| PA5611  |              | WM3351  |        |
| PA5621  |              | WM4511  |        |
| PA5651  |              | WM5131  |        |
| PA6211  |              | WM5161  |        |
| PA6311  |              | WM5311  |        |
| PA7911  |              | WM5601  |        |
| PA8031  |              | WM5611  |        |
| Column Mount<br>*See Page 3 for Style/Size    |              |   |        |
| CM  | Column Mount |   |        |

**8** **FINISHES**

| Standard Grade | Marine Grade             | Standard Grade | Marine Grade                      |
|----------------|--------------------------|----------------|-----------------------------------|
| 40             | NA Raw Unfinished        | 53             | 100 Copper Clay                   |
| 41             | 101 Black                | 56             | 109 Silver                        |
| 42             | 102 Forest Green         | 61             | 106 Black Verde                   |
| 43             | 114 Bright Red           | 70             | 118 Painted Chrome                |
| 44             | 107 White                | 71             | 105 Painted Copper                |
| 45             | 112 Bright Blue          | 72             | 108 Textured Black                |
| 46             | 123 Sunny Yellow         | 73             | 125 Matte Black                   |
| 47             | 120 Aqua Green           | 76             | 121 Textured Architectural Bronze |
| 49             | NA Galvanized            | 77             | 127 Textured White                |
| 50             | 111 Navy                 | 78             | 124 Textured Silver               |
| 51             | 103 Architectural Bronze | 10             | 130 Aspen Green                   |
| 52             | 104 Patina Verde         | 11             | 131 Cantaloupe                    |
| 12             | 133 Lilac                | 13             | 132 Putty                         |

Consult factory for additional paint charges and availability

Project: \_\_\_\_\_  
 Fixture Type: \_\_\_\_\_ Quantity: \_\_\_\_\_  
 Customer: \_\_\_\_\_

**LED PERFORMANCE**

**MODULE**

| LED Wattage | CCT   | Typical Luminous Flux | System Wattage | Typical Efficacy |
|-------------|-------|-----------------------|----------------|------------------|
| 16W         | 2700K | 2000                  | 19W            | 125              |
|             | 3000K | 2000                  | 19W            | 125              |
|             | 3500K | 2000                  | 19W            | 125              |
|             | 4000K | 2000                  | 19W            | 125              |
| 24W         | 2700K | 3000                  | 28W            | 125              |
|             | 3000K | 3000                  | 28W            | 125              |
|             | 3500K | 3000                  | 28W            | 125              |
|             | 4000K | 3000                  | 28W            | 125              |

**MODULE SPECIFICATION**

- Efficacy 65-125 lumens per watt
- Life: L70 50,000 hours
- Color temp: 2700K,3000K,3500K and 4000K
- CRI: >90

**MODULE DRIVER SPECIFICATION**

- Input Voltage: 120-277 Volts; 50/60Hz
- Dimmable down to 1%
- 0-10V, TRIAC and ELV dimming protocols are standard.
- Output Current: Constant Current: 440mA to 940mA (model dependent)
- Driver Efficiency > 80%; Power Factor > 0.9
- Integral Surge Protection in conformance to ANSI C62.41 Category A

**MODULE LISTINGS**

- Fully compliant with the RoHS Directive
- Certifications: CE/UL

**WARRANTY**

See [www.ANPlighting.com](http://www.ANPlighting.com) for complete fixture warranty.

- 5 year limited warranty on Modules/Drivers

\*Limited Warranty: A typical year is defined as 4380 hours of operation.

Project: \_\_\_\_\_

Fixture Type: \_\_\_\_\_ Quantity: \_\_\_\_\_

Customer: \_\_\_\_\_

**POST MOUNTS** - See Post Arm Section on Website for Specification Sheets and additional post arms.  
Dimensions are Projection x Height

**COLUMN MOUNT**



PA3321 / 18" x 14 3/4"



PA5151 / 14 1/4" x 19 3/4"

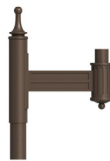

PA5411 / 17 7/8" x 25 1/8"



PA5611 / 18 5/8" x 26 1/2"



CM / 5 3/4" SQ x 3 1/2" H



PA5621 / 19" x 26 1/4"



PA5651 / 20" x 26 1/4"



PA6211 / 22 3/4" x 26 1/2"



PA6311 / 17" x 23 1/4"



PA7911 / 20" x 20 5/8"



PA8031 / 20 1/2" x 20 1/4"



PA8521 / 18 1/4" x 14 1/2"



PA8571 / 24" x 47"

**WALL MOUNTS** - See Wall Mount Section on Website for Specification Sheets and additional wall mount arms.  
Dimensions are Projection x Height



WM2141 / 18" x 12 3/16"



WM2211 / 15 1/2" x 15 7/8"



WM3001 / 11" x 8 7/8"



WM3351 / 14 1/2" x 17"



WM4511 / 17" x 8"



WM5131 / 11" x 16 3/8"



WM5161 / 15 3/4" x 17 3/4"



WM5311 / 10 7/8" x 10"



WM5601 / 17 7/8" x 14"



WM5611 / 17 5/8" x 22"



WM7421 / 16 3/8" x 15 3/4"



WM8021 / 19 1/4" x 16 3/8"

**ACCESSORIES**



HSS90 & HSS120



EMG-LED5, 7, 10



HLMSPC-06 & HLMSPC-10



PC



TLPC



TL



TL5 & TL7