

Project: \_\_\_\_\_

Fixture Type: \_\_\_\_\_ Quantity: \_\_\_\_\_

Customer: \_\_\_\_\_

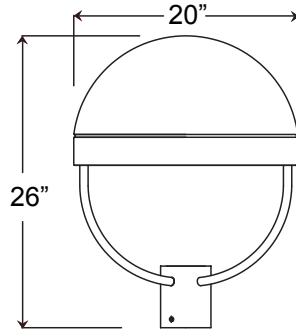

**Specifications**

**Material:**  
All parts are high strength aluminum. All hardware provided shall be stainless steel or zinc plated steel.

**Fixture Mounting:**  
Post mount: Post Cap with set screws. Fits 3" and 4" poles.

**Drivers:**  
Universal voltage 120-277 is standard. 0-10V dimming is standard for LED platforms.

See page 2 table for LED engine and driver specs, voltage and dimming protocols.

**Electrical:**  
Approximately 12" of pull wire extends from luminaire. Additional pull wire provided for post mount arms and wall mounts.



**Finish:**  
A polyester powder coat high quality finish is electro-statically applied and baked at 430° for exceptional durability and color retention. Products undergo an intensive five-step cleansing and pretreatment process for maximum paint adhesion.

Marine grade finish provides superior salt, humidity and UV protection. This coating withstands up to 3000 hours of continuous salt spray, comes with a 5-year warranty and is available in either a textured or gloss surface.

**Modifications:**  
Consult factory for custom or modified designs.

**LA383  
LED**

Weight: 21.5 lbs  
EPA: 1.2

Catalog Logic

LA383 1 P117LD4 D T5 40K - PC - PA8031 - 72

Luminaire Series    Pendant or Post Mount    Light Source & Wattage    Dimming    Optics    CCT    Accessories    Mounting Source    Finish

| Catalog Number | 1     | 2 | 3 | 4 | 5 | 6 | 7 | 8 |
|----------------|-------|---|---|---|---|---|---|---|
|                | LA383 | 1 | D |   |   |   |   |   |

**1 FIXTURE ORIENTATION**

|        |
|--------|
| 1 Post |
|--------|

**2 LIGHT SOURCE & WATTAGES**

|                                       |
|---------------------------------------|
| P029LD4 (29 w Platform; 400ma Driver) |
| P046LD4 (46w Platform; 400ma Driver)  |
| P078LD4 (78w Platform; 400ma Driver)  |
| P117LD4 (117w Platform; 400ma Driver) |

**3 DIMMING**

|             |
|-------------|
| D (Dimming) |
|-------------|

See page 2 table for LED engine and driver specs, voltage and dimming protocols.

**4 OPTICS**

|               |
|---------------|
| T2 (Type II)  |
| T3 (Type III) |
| T5 (Type V)   |

**5 COLOR TEMPERATURE (CCT)**

|             |
|-------------|
| 27K (2700K) |
| 30K (3000K) |
| 35K (3500K) |
| 40K (4000K) |

**6 ACCESSORIES**

|   |
|---|
| HSS90 (90° House Side Shield, polished)   |
| HSS120 (120° House Side Shield, polished)   |
| *EMG-LED20HV (20w, High Voltage LED Emergency Driver, remote placement, for use with Platforms and Towers, 78w or less) |
| HLMSPC-06 (High-Low Motion Sensor/Photocell; 15' - 30' Sensor Mounting Height)  |
| HLMSPC-10 (High-Low Motion Sensor/Photocell; 8' - 15' Sensor Mounting Height)   |
| PC (Button Photo Cell)  |
| SP (Surge Protector, 10kA & 10kV)   |
| TLPC (Twist Lock photo cell & receptacle)   |
| TL (Twist Lock receptacle only)   |
| TL5 (5-pin Twist Lock receptacle only)  |
| TL7 (7-pin Twist Lock receptacle only)  |

\*For Emergency lumen output data, see Resources section at [www.ANPlighting.com](http://www.ANPlighting.com).

**7 MOUNTING SOURCE**

| Post Mount Arms<br>*See Page 3 for Style/Size |              | Wall Mount Arms<br>*See Page 3 for Style/Size |        |
|---|--------------|---|--------|
| PA3111  | PA8521       | WM2141  | WM8581 |
| PA3321  | PA8571       | WM2211  |        |
| PA5151  |              | WM2221  |        |
| PA5171  |              | WM4511  |        |
| PA5411  |              | WM5131  |        |
| PA6111  |              | WM5161  |        |
| PA6211  |              | WM5601  |        |
| PA7711  |              | WM6111  |        |
| PA7911  |              | WM7411  |        |
| PA8031  |              | WM7421  |        |
| Column Mount<br>*See Page 3 for Style/Size    |              |   |        |
| CM  | Column Mount |   |        |

**8 FINISHES**

| Standard Grade | Marine Grade |                      | Standard Grade | Marine Grade |
|----------------|--------------|----------------------|----------------|--------------|
| 40             | NA           | Raw Unfinished       | 53             | 100          |
| 41             | 101          | Black                | 56             | 109          |
| 42             | 102          | Forest Green         | 61             | 106          |
| 43             | 114          | Bright Red           | 70             | 118          |
| 44             | 107          | White                | 71             | 105          |
| 45             | 112          | Bright Blue          | 72             | 108          |
| 46             | 123          | Sunny Yellow         | 73             | 125          |
| 47             | 120          | Aqua Green           | 76             | 121          |
| 49             | NA           | Galvanized           | 77             | 127          |
| 50             | 111          | Navy                 | 78             | 124          |
| 51             | 103          | Architectural Bronze | 10             | 130          |
| 52             | 104          | Patina Verde         | 11             | 131          |
| 12             | 133          | Lilac                | 13             | 132          |

Consult factory for additional paint charges and availability

Project: \_\_\_\_\_

Fixture Type: \_\_\_\_\_ Quantity: \_\_\_\_\_

Customer: \_\_\_\_\_

**LED PERFORMANCE**

**PLATFORM**

| LED Wattage | CCT   | Typical Luminous Flux | System Wattage | Typical Efficacy |
|-------------|-------|-----------------------|----------------|------------------|
| 29W         | 2700K | 2670                  | 30w            | 89               |
|             | 3000K | 2670                  | 30w            | 89               |
|             | 3500K | 3209                  | 30w            | 107              |
|             | 4000K | 3465                  | 30w            | 116              |
| 46W         | 2700K | 4004                  | 46w            | 87               |
|             | 3000K | 4004                  | 46w            | 87               |
|             | 3500K | 4814                  | 46w            | 105              |
|             | 4000K | 5197                  | 46w            | 115              |
| 78W         | 2700K | 7041                  | 80w            | 88               |
|             | 3000K | 7041                  | 80w            | 88               |
|             | 3500K | 8464                  | 80w            | 106              |
|             | 4000K | 9138                  | 80w            | 114              |
| 117W        | 2700K | 10561                 | 120w           | 88               |
|             | 3000K | 10561                 | 120w           | 88               |
|             | 3500K | 12696                 | 120w           | 106              |
|             | 4000K | 13707                 | 120w           | 114              |

**PLATFORM SPECIFICATION:**

- Efficacy ranges from 80-116 lumens per watt
- Customized lens precisely directs the light
- Operating temperature of -30C to 55C
- Life: L70 is 60,000 hours
- PLATFORM CCT: 2700K, 3000K, 3500K, and 4000K
- TOWER CCT: 4000K
- CRI: >70
- Parallel circuitry ensures consistent light output in the event of single LED failure

**PLATFORM DRIVER SPECIFICATION:**

- Operates at 400mA
- Dimmable down to 10%
- Built in surge protection
- Constant current output 50/60HZ
- Driver Efficiency > 90% power factor above 99%
- 120 – 277 volts
- 0-10V dimming protocol is standard

**PLATFORM LISTINGS**

- Fully compliant with the RoHS Directive
- Certifications: ETL
- Rated IP65 with an optional IP66 rating

**WARRANTY**

See [www.ANPlighting.com](http://www.ANPlighting.com) for complete fixture warranty.

- 7 year limited warranty\* on Platform LED engines
- 5 year limited warranty\* on Platform Drivers

\*Limited Warranty: A typical year is defined as 4380 hours of operation. Failure defined as more than 10% of the total platform LED's not operating.

Project: \_\_\_\_\_

Fixture Type: \_\_\_\_\_ Quantity: \_\_\_\_\_

Customer: \_\_\_\_\_

**POST MOUNTS** - See Post Arm Section on Website for Specification Sheets and additional post arms.  
Dimensions are Projection x Height

**COLUMN MOUNT**

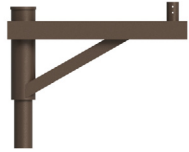

PA3111 / 25" x 15 1/4"



PA3321 / 18" x 14 3/4"



PA5151 / 14 1/4" x 19 3/4"



PA5171 / 15 1/4" x 25 5/8"



CM / 5 3/4" SQ x 3 1/2" H



PA5411 / 17 7/8" x 25 1/8"



PA6111 / 20 1/2" x 25 1/8"



PA6211 / 22 3/4" x 26 1/2"



PA7711 / 13 1/8" x 21 1/2"



PA7911 / 20" x 20 5/8"



PA8031 / 20 1/2" x 20 1/4"

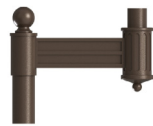

PA8521 / 18 1/4" x 14 1/2"



PA8571 / 24" x 47"

**WALL MOUNTS** - See Wall Mount Section on Website for Specification Sheets and additional wall mount arms.  
Dimensions are Projection x Height.



WM2141 / 18" x 12 3/16"



WM2211 / 15 1/2" x 15 7/8"



WM2221 / 13 1/2" x 13 1/4"



WM4511 / 17" x 8"



WM5131 / 11" x 16 3/8"



WM5161 / 15 3/4" x 17 3/4"



WM5601 / 17 7/8" x 14"



WM6111 / 20 3/8" x 24"



WM7411 / 14" x 15 3/4"



WM7421 / 16 3/8" x 15 3/4"



WM8581 / 17 1/8" x 17 1/2"

**ACCESSORIES**



HSS90 & HSS120



EMG-LED20HV



HLMSPC-06 & HLMSPC-10



PC



TLPC



TL



TL5 & TL7