

Project: _____

Fixture Type: _____ Quantity: _____

Customer: _____

Specifications



Illuminating
ENGINEERING SOCIETY

Material:

Shade is 0.80" spun aluminum. Cap and Lens ring are 356 cast aluminum. All fasteners are stainless steel. Inside of shade is reflective white finish for all colors except galvanized paint finish. Screw hardware may not match paint.

Electrical:

Universal voltage 120-277 is standard. 0-10V, TRIAC and ELV dimming protocols are standard. (24w is 0-10v only) See page 2 table for LED module and driver specs, voltage and dimming protocols.

Certifications:

Cord mounts are UL Listed for dry locations. Arm mount, stem mount and wall mount are UL Listed for wet locations.

Finish:

A polyester powder coat high quality finish is electro-statically applied and baked at 430° for exceptional durability and color retention. Products undergo an intensive five-step cleansing and pretreatment process for maximum paint adhesion.

Marine grade finish provides superior salt, humidity and UV protection. This coating withstands up to 3000 hours of continuous salt spray, comes with a 5-year warranty and is available in either a textured or gloss surface.

Modifications:

Consult factory for custom or modified luminaires.

MA08

Weight: 3.0 lbs

LED

Catalog Logic

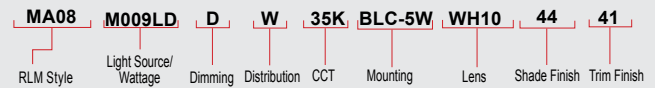

Catalog Number

1	2	3	4	5	6	7	8
MA08	M009LD	D	W	35K	BLC-5W	WH08	

1 LIGHT SOURCE & WATTAGES	
GU24	(GU24 Socket Only)
M012LD	(12w, 750 lumen, Cree module) Integral driver, 120V, dimming & narrow distribution only.
M009LD	(9w, 850 lumen, Cree module)
M010LD	(10w, 1250 lumen, Cree module)
M016LD	(16w, 2000 lumen, Cree module)

2 DIMMING	
D	(Standard 0-10v, TRIAC and ELV dimming)
S	(Sunset dimming- Dims smoothly from 2700K to 1800K; 9w only)
*12w is dimming only, select "D".	
See page 2 for dimming protocols and limitations.	

3 DISTRIBUTION	
W	(T5 Wide Distribution with Dome LED Lens)
N*	(T5 Narrow Distribution with Flat LED Lens)
*12w is narrow only, select "N".	

4 COLOR TEMPERATURE (CCT)	
27K	(2700K)
30K	(3000K) (Not Sunset Dim)
35K	(3500K) (Not Sunset Dim)
40K	(4000K) (Not Sunset Dim)

5 MOUNTING	
Arm Mounts	
E3110	
E3410	
E3510	
Wall Mounts	
WM905	
Cord Mounts	
BLC-5W	(6' black cord with 1" x 5 3/8" canopy)
WHC-5W	(6' white cord with 1" x 5 3/8" canopy)
Stem Mount	
1/2" (13/16" OD Rigid Stems with STC Flat Canopy)	
2ST6 2ST12 2ST18 2ST24 2ST36 2ST48	
2ST60 2ST72 2ST96	
3/4" (1" OD Rigid Stems with STC Flat Canopy)	
3ST6 3ST12 3ST18 3ST24 3ST36 3ST48	
3ST60 3ST72 3ST96	

6 LENS	
NL	(No Lens)
CL08	(Clear Flat Acrylic Lens)
WH08	(White Flat Acrylic Lens)

7 FINISHES					
Standard Grade	Marine Grade		Standard Grade	Marine Grade	
40	NA	Raw Unfinished	53	100	Copper Clay
41	101	Black	56	109	Silver
42	102	Forest Green	61	106	Black Verde
43	114	Bright Red	70	118	Painted Chrome
44	107	White	71	105	Painted Copper
45	112	Bright Blue	72	108	Textured Black
46	123	Sunny Yellow	73	125	Matte Black
47	120	Aqua Green	76	121	Textured Architectural Bronze
49	NA	Galvanized	77	127	Textured White
50	111	Navy	78	124	Textured Silver
51	103	Architectural Bronze	10	130	Aspen Green
52	104	Patina Verde	11	131	Cantaloupe
12	133	Lilac	13	132	Putty
Premium Grade	Marine Grade		Premium Grade	Marine Grade	
81	129	Extreme Chrome	64	116	Candy Apple Red
80	117	Textured Desert Stone	65	122	Cobalt Blue
67	119	Butterscotch	82	128	Graystone
66	115	Caramel	69	113	Gunmetal Gray
68	126	Black Silver	83	134	Oil Rubbed Bronze

Consult factory for additional paint charges and availability

8 TRIM FINISHES	
NOTE: Trim includes bottom trim, cap, canopy hardware and mounting.	
See Shade Finish Color Chart to choose Trim Finish.	

Project: _____

Fixture Type: _____ Quantity: _____

Customer: _____



illuminating
ENGINEERING SOCIETY

MODULE SPECIFICATION:

- Efficacy 65-125 lumens per watt
- Dimmable down to 1%
- Life: L70 50,000 hours
- Color temp: 2700K,3000K,3500K and 4000K
- CRI: >90

MODULE DRIVER SPECIFICATION:

- Input Voltage: 120-277 Volts; 50/60Hz
- 0-10V, TRIAC and ELV dimming protocols are standard. (24w is 0-10v only)
- Output Current: Constant Current; 440mA to 940mA (model dependent)
- Driver Efficiency > 80%; Power Factor > 0.9
- Integral Surge Protection in conformance to ANSI C62.41 Category A

MODULE LISTINGS

- Fully compliant with the RoHS Directive
- Certifications: CE/UL

LED MODULE SPECIFICATIONS

LED Wattage	CCT	Typical Luminous Flux	System Wattage	Typical Efficacy
9W	2700K	850	11W	97
	3000K	850	11W	97
	3500K	850	11W	97
	4000K	850	11W	97
10W	2700K	1250	12W	125
	3000K	1250	12W	125
	3500K	1250	12W	125
	4000K	1250	12W	125
12W	2700K	750	12W	65
	3000K	750	12W	65
	3500K	750	12W	65
	4000K	750	12W	65
16W	2700K	2000	19W	125
	3000K	2000	19W	125
	3500K	2000	19W	125
	4000K	2000	19W	125

WARRANTY

See www.anplighting.com for complete fixture warranty.

LED warranty information

- 5 year limited warranty*

*Limited Warranty: A typical year is defined as 4380 hours of operation.

Project: _____

Fixture Type: _____ Quantity: _____

Customer: _____



illuminating
ENGINEERING SOCIETY

PENDANT MOUNTS

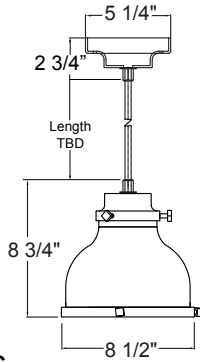

MA08-BLC

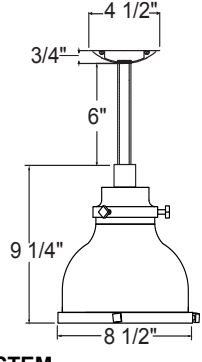

MA08-STEM

ARM MOUNTS

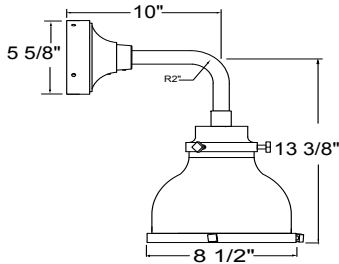

MA08-E3110

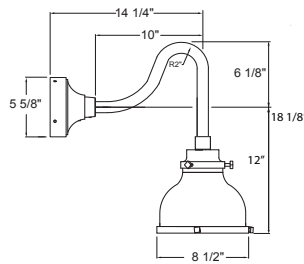

MA08-E3410

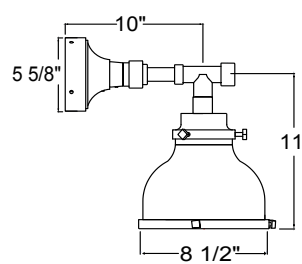

MA08-E3510

WALL MOUNTS

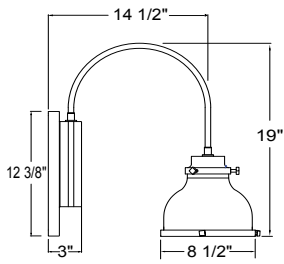

MA08-WM905