

Project Name: \_\_\_\_\_

Fixture Type: \_\_\_\_\_ Quantity: \_\_\_\_\_

Customer: \_\_\_\_\_



Illuminating  
ENGINEERING SOCIETY

Weight: 10.6 lbs

EPA: 1.38

**Specifications**

**General:**  
Due to size or weight, arms mounts may not accommodate all ANP luminaires.

**Material:**  
All parts are durable 356 cast aluminum and high strength extruded aluminum. All hardware provided shall be stainless steel or zinc plated steel.

**Fixture Mounting:**  
Fixtures mount by 2 3/8" x 4" Tenon.

**Post Arm Mounting:**  
Tenon mount to accommodate 3", 4", 5" and 6" and 0.188 wall pole.

**Electrical:**  
Pull wire provided.

**Finish:**  
A polyester powder coat high quality finish is electro-statically applied and baked at 430° for exceptional durability and color retention. Products undergo an intensive five-step cleansing and pretreatment process for maximum paint adhesion.

Marine grade finish provides superior salt, humidity and UV protection. This coating withstands up to 3000 hours of continuous salt spray, comes with a 5-year warranty and is available in either a textured or gloss surface.

**Modifications:**  
Consult factory for custom or modified designs.

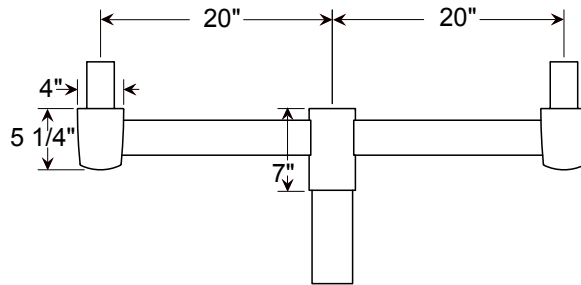
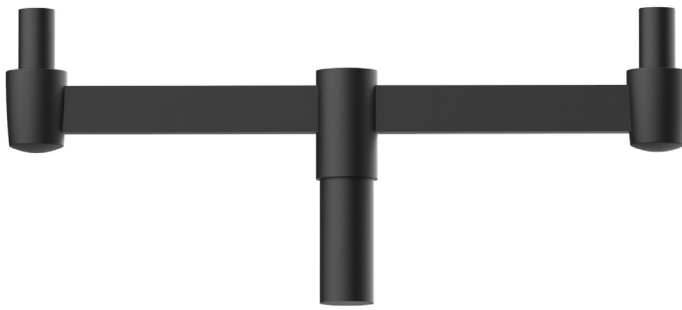

**PA122 - POST ARM**

Cast aluminum double post arm for post fixture, 4" crucible and 20" Length Arm.

**Catalog Logic**

**PA122** - **1** - **2** - **N/A** - **4** - **S** - **72**

Post Arm Style    Pendant Post    Number of Arms    Center Mount    Pole Diameter    Pole Style    Finish

**Catalog Number**

**PA122**    **1** - **2** - **N/A**    **4**    **5**    **6**

**2 Arm Configuration**

**1 POST ARM ORIENTATION**

1 Post

**2 NUMBER OF ARMS**

2 Two Arm Configuration

**3 CENTER MOUNT OPTIONS**

N/A

**4 POLE DIAMETER**

3 3 Inch

4 4 Inch

5 5 Inch

6 6 Inch

**5 POLE STYLE**

S Smooth

F Fluted

**6 FINISHES**  
\*Marine Grade Finish requires an additional charge, consult factory.

Standard Colors	Standard Grade	Marine Grade*	Premium Colors	Premium Grade	Marine Grade*
Aspen Green	10	10M	Silver	56	56M
Cantaloupe	11	11M	Black Verde	61	61M
Lilac	12	12M	Painted Chrome	70	70M
Putty	13	13M	Painted Copper	71	71M
Raw Unfinished	40	NA	Textured Black	72	72M
Black	41	41M	Matte Black	73	73M
Forest Green	42	42M	Textured Architectural	76	76M
Bright Red	43	43M	Textured White	77	77M
White	44	44M	Textured Silver	78	78M
Bright Blue	45	45M	High Gloss Black	01	01M
Sunny Yellow	46	46M	Arctic Silver	14	14M
Aqua Green	47	47M	Mayan Gold	79	NA
Galvanized	49	NA	Textured Desert Stone	80	80M
Navy	50	50M	Graystone	82	82M
Architectural Bronze	51	51M	Oil Rubbed Bronze	83	83M
Patina Verde	52	52M	Carbon Graphite	96	96M
Copper Clay	53	53M			

Consult Factory for additional paint options, charges & availability.