

Quick Ship

Project: _____

Fixture Type: _____ Quantity: _____

Customer: _____



Illuminating
ENGINEERING SOCIETY

Specifications

Material:
All parts are durable 356 cast aluminum and high strength extruded aluminum.

Shaft is 4" diameter and wall thickness of 0.188. All hardware provided shall be stainless steel or zinc plated steel.

Mounting:
Standard anchor bolts provided are 3/4" x 18" x 3". Bolts, nuts and washers shall be hot dipped galvanized steel.

Bolt pattern diameter is 6 1/2" X 7" rectangular.

Access
Hand access opening and cover are provided in cast base. Hand hole cover is secured by two stainless steel machine screws. (Tamper-proof screws provided upon request). See drawing for position of hand hole.

7" bottom hole provided for conduit access.

Grounding
All cast bases are provided with an aluminum grounding lug integrated to inner wall of shaft, 180 degrees to hand hole. Grounding lug is drilled and tapped to accommodate 1/4-20 stainless steel machine screw.

Pole Height
Maximum pole height is 14 feet.

Finish:
A polyester powder coat high quality finish is electro-statically applied and baked at 430° for exceptional durability and color retention. Products undergo an intensive five-step cleansing and pretreatment process for maximum paint adhesion.

Marine grade finish provides superior salt, humidity and UV protection. This coating withstands up to 3000 hours of continuous salt spray, comes with a 5-year warranty and is available in either a textured or gloss surface.

Modifications:
Consult factory for custom or modified designs.

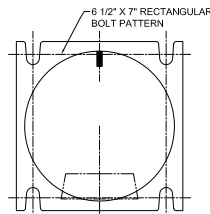
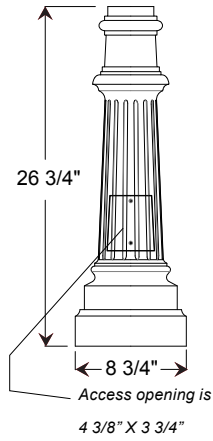

Q-CB0300

Weight: 11 lbs.
Anchor Bolts: 4

Catalog Logic		
Q-CB0300	4S14.188	76
Cast Base	Shaft	Finish

Catalog Number	1	2
Q-CB0300	4S14.188	76

1 Additional heights and pole diameters may be available. Contact factory for your specific needs.

Shaft Diameter	Finished Height	Wall Thickness	Smooth Shaft Catalog No.	Fluted Shaft Catalog No.
3"	6'	.125	CB0300-3S6.125	CB0300-3F6.125
3"	8'	.125	CB0300-3S8.125	CB0300-3F8.125
3"	9'	.125	CB0300-3S9.125	-
3"	10'	.125	CB0300-3S10.125	-
3"	10'	.188	CB0300-3S10.188	-
3"	11'	.188	CB0300-3S11.188	-
3"	12'	.188	CB0300-3S12.188	-
4"	8'	.125	CB0300-4S8.125	-
4"	9'	.125	CB0300-4S9.125	-
4"	10'	.125	CB0300-4S10.125	-
4"	8'	.188	-	CB0300-4F8.188
4"	9'	.188	-	CB0300-4F9.188
4"	10'	.188	-	CB0300-4F10.188
4"	11'	.188	-	CB0300-4F11.188
4"	12'	.188	CB0300-4S12.188	CB0300-4F12.188
4"	13'	.188	CB0300-4S13.188	CB0300-4F13.188
4"	14'	.188	CB0300-4S14.188	CB0300-4F14.188

2 FINISHES

Standard Grade	Marine Grade	Standard Grade	Marine Grade
40	NA	53	100
41	101	56	109
42	102	61	106
43	114	70	118
44	107	71	105
45	112	72	108
46	123	73	125
47	120	76	121
49	NA	77	127
50	111	78	124
51	103	10	130
52	104	11	131
12	133	13	132

Consult factory for additional paint charges and availability